

RAYTOOLS

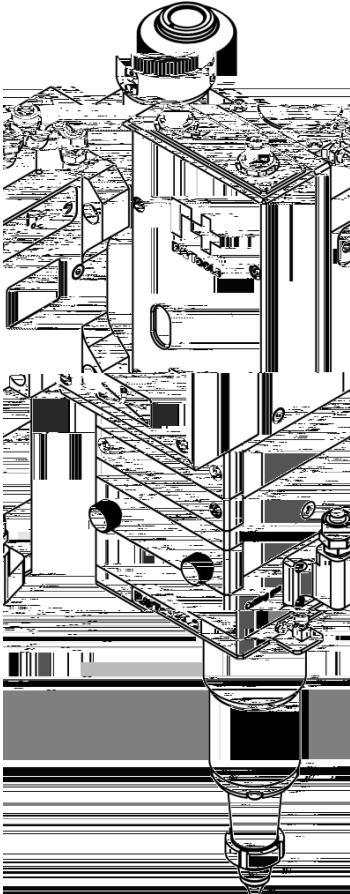

Edit date	Version	Topic, revision, action taken

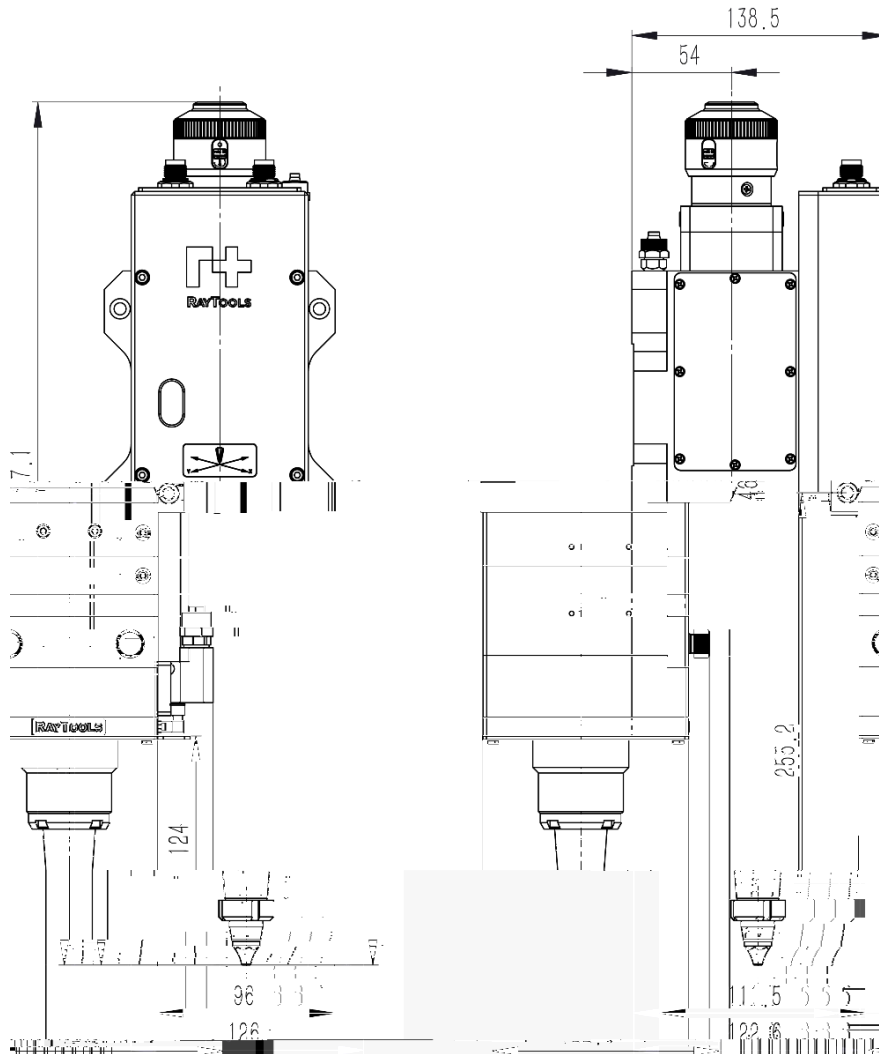



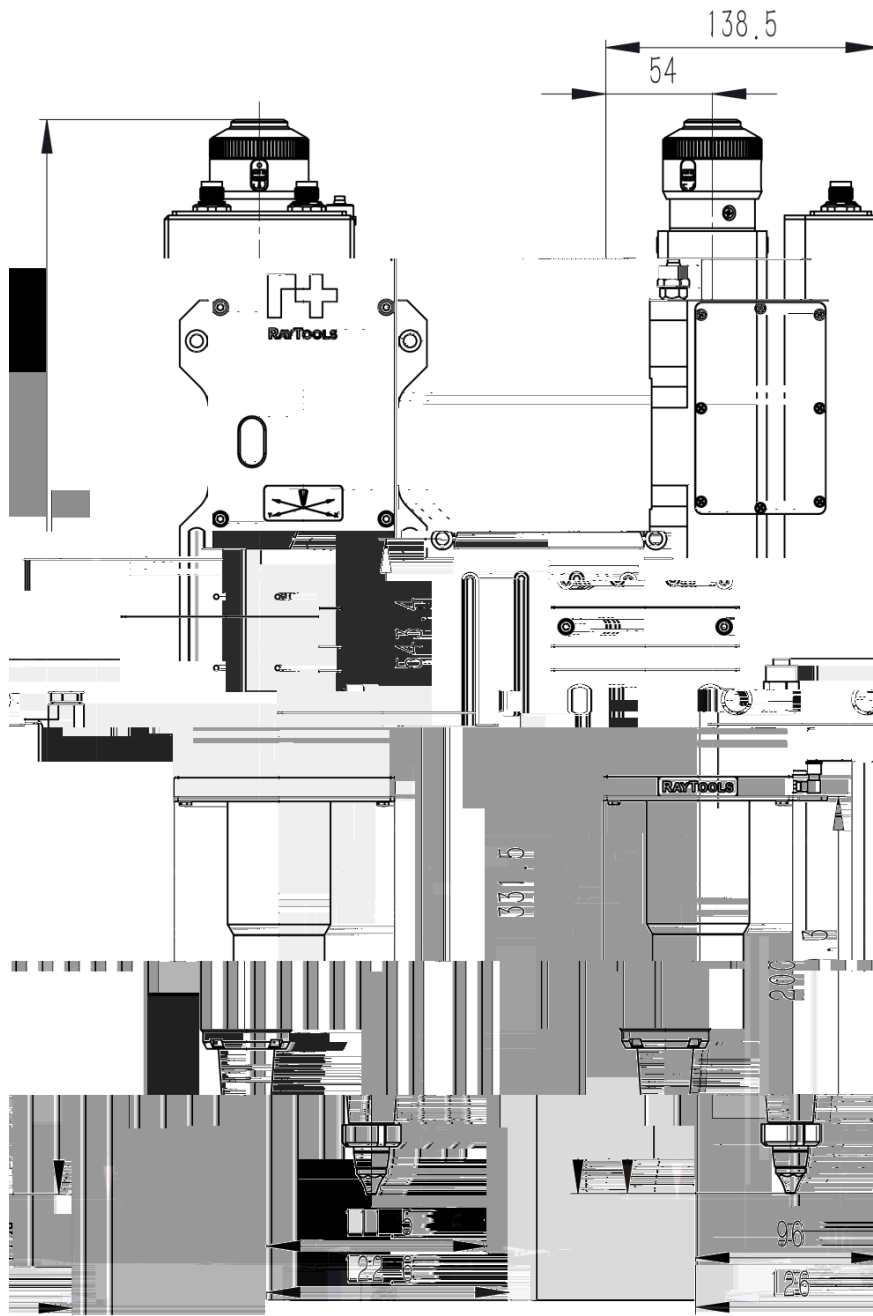

--	--	--	--

2 Mechanical Installation

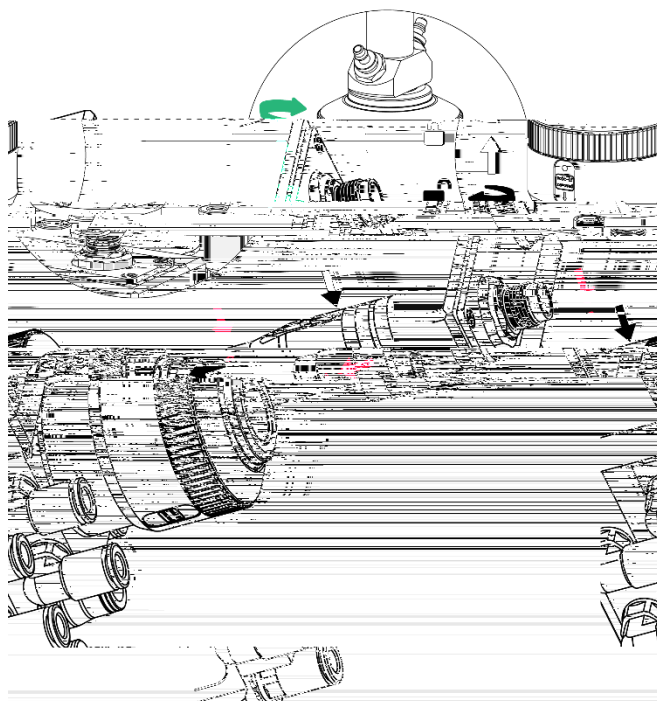

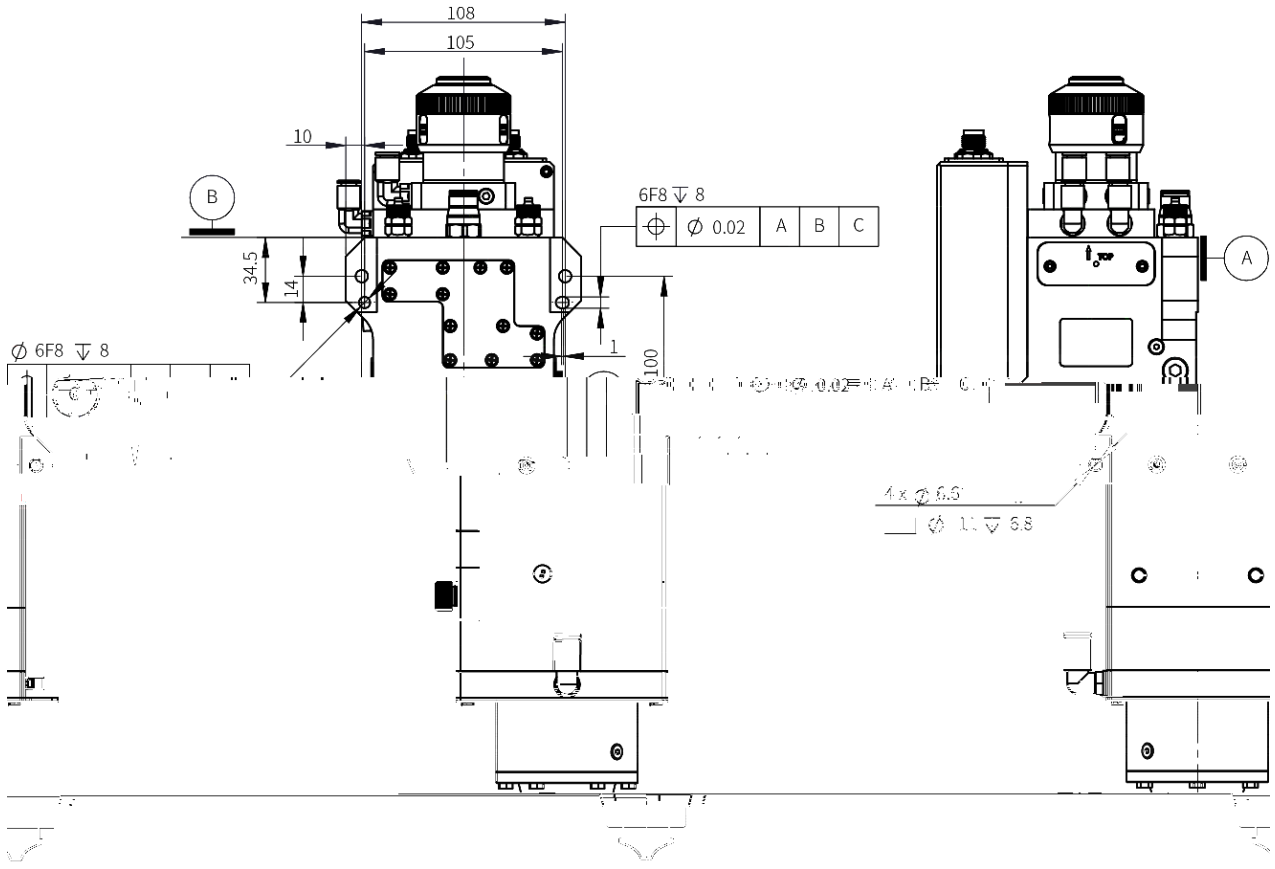

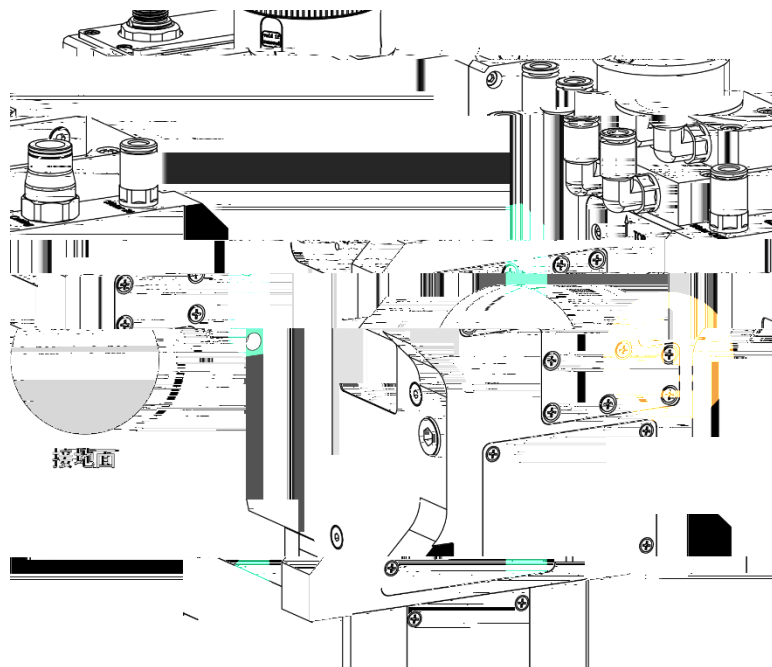

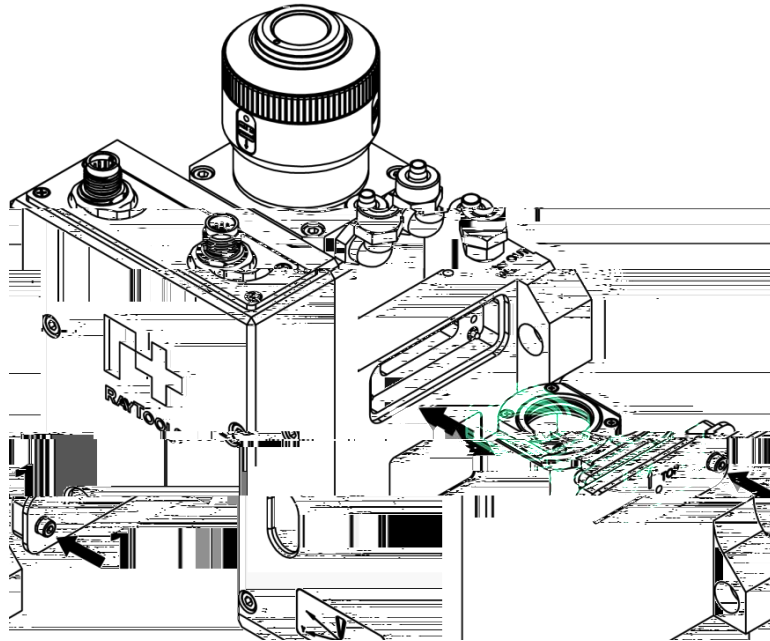

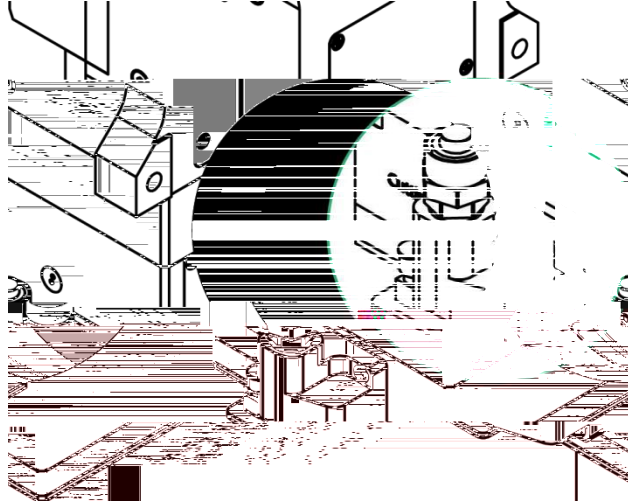

		()	()
	>		
	>		



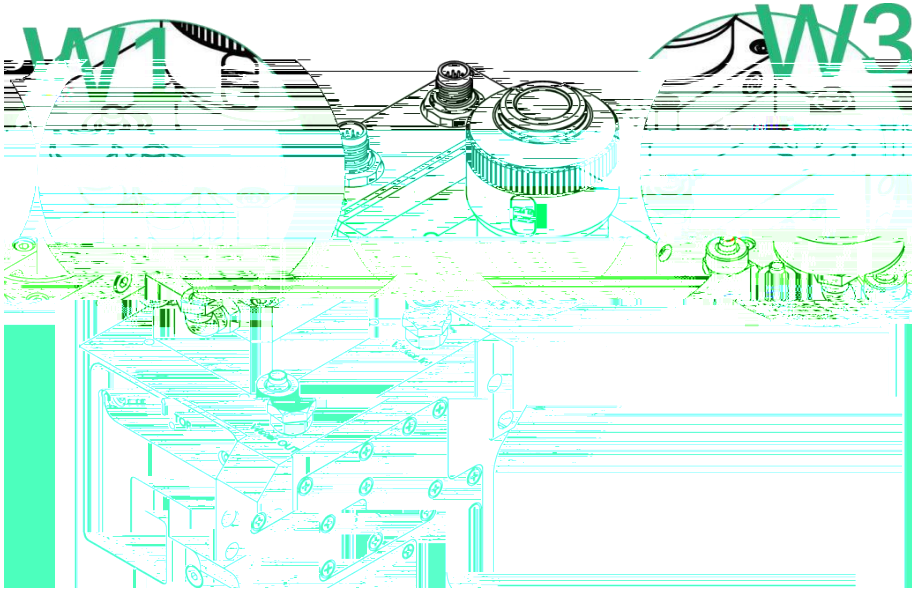

□



3 Connection and Commissioning

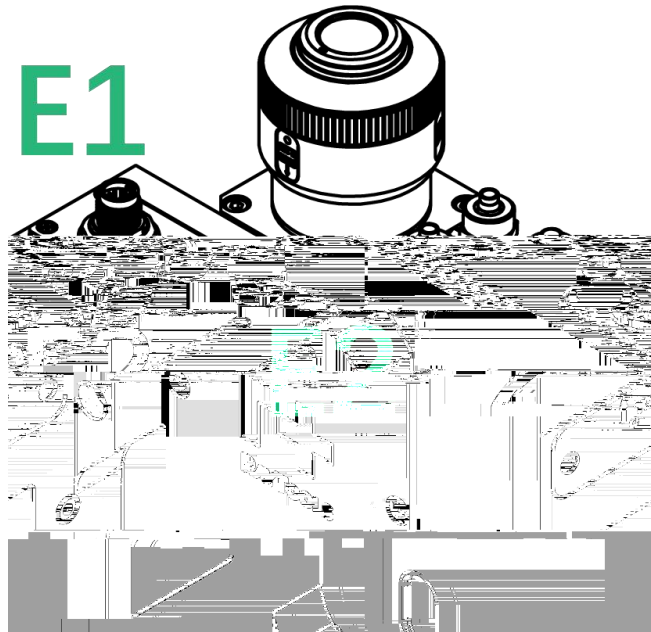

Raytools

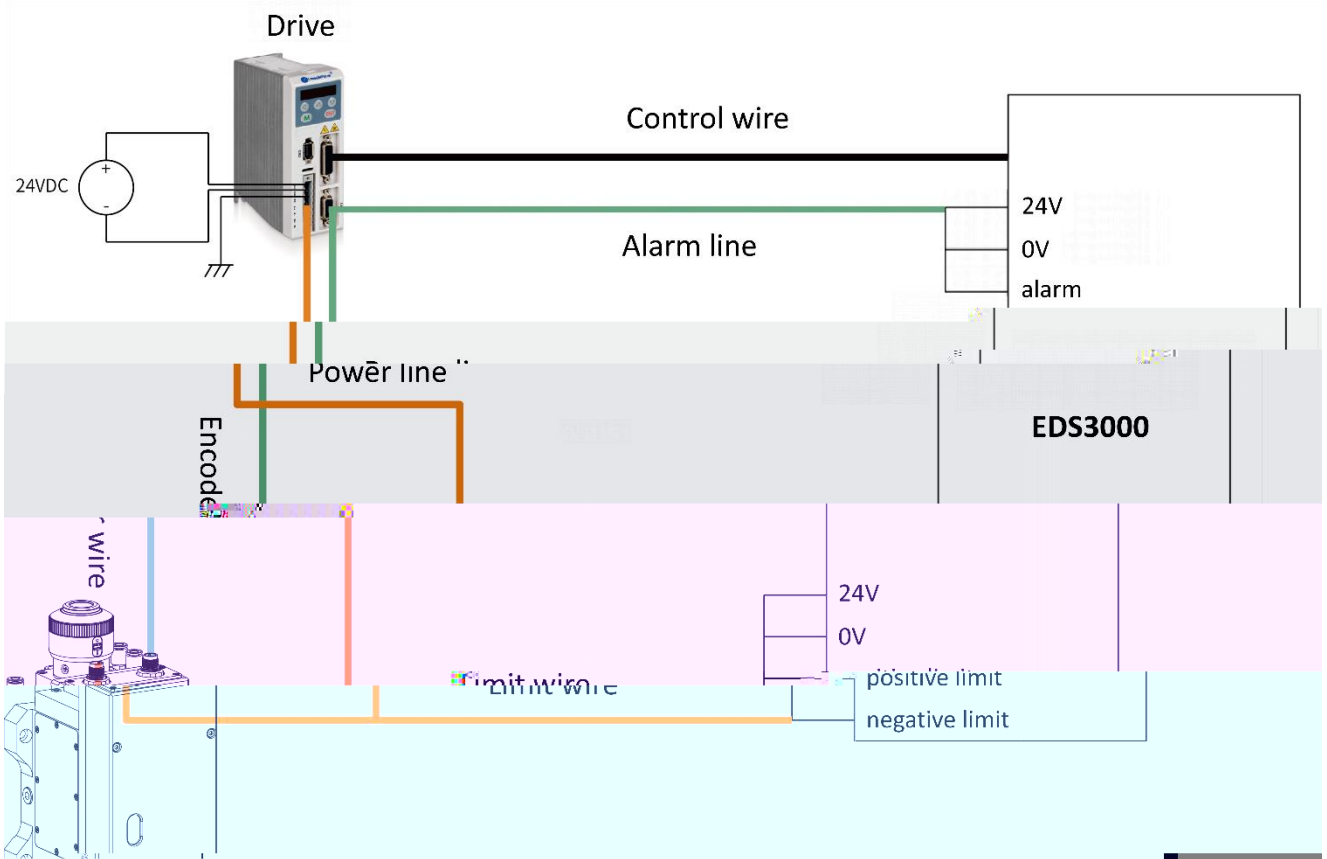



-NC



NPN-NC,

Laser head

Brand: Raytools

Model: BM06K 100:200

Height sensor signal port: Node 4:Height Sensor Capacitance

Focus control port/servo: Node 4:Focus Axis (EDS Onboard)

Use Other Driver:

Focus adjmt: Servo Parameter

Motor direction: Negative

Pulse number: 4000

Pitch: 15mm

Max follow-up offset: 10mm

Return to Origin Parameter

Homing mode: Incremental Mode

Return origin direction a...: Negative

Return origin speed: 0.5m/min

Back Distance: 72mm

Coordinate aft backward...: 0

Manual Speed

Manual slow: 0.3m/min

Manual fast: 0.6m/min

Auto Speed

Speed: 6m/min

Acceleration: 1500mm/s²

Acc time: 100ms

Axis point and limit configuration

Positive hard limit...: Node 4:DI_12

Negative hard lim...: Node 4:DI_11

Soft limit range: -32 ~ 32 mm

Cutting head alarm: Node 4:DI_16

Shield cutting he...:

Restore default data

Restore default model list

Laser head

Brand: Raytools

Model: BM06K 100:200

Height sensor signal port: Node 4:Height Sensor Capacitance

Focus control port/servo: Node 4:Focus Axis (EDS Onboard)

Use Other Driver:

Focus adjmt: Servo Parameter

Motor direction: Negative

Pulse number: 4000

Pitch: 15mm

Max follow-up offset: 10mm

Return to Origin Parameter

Homing mode: Incremental Mode

Return origin direction a...: Negative

Return origin speed: 0.5m/min

Back Distance: 72mm

Coordinate aft backward...: 0

Manual Speed

Manual slow: 0.3m/min

Manual fast: 0.6m/min

Auto Speed

Speed: 6m/min

Acceleration: 1500mm/s²

Acc time: 100ms

Axis point and limit configuration

Positive hard limit...: Node 4:DI_12

Negative hard lim...: Node 4:DI_11

Soft limit range: -72 ~ 72 mm

Cutting head alarm: Node 4:DI_16

Shield cutting he...:

Restore default data

Restore default model list



Please set pulse number as 10000 when applying EtherCAT driver.

SR

Focus Control

Enable

The fourth
 Precitec
 HighYAG
 Procutter-Zoom
 Ecac Ext Board[No Co:

Range: From to

Focus position at Or:

Pulse equivalent Move: need pulse

High Speed: Origin Dir: Pos Neg

Low Speed: ORG signal:

Rollback distance:

Jog speed:

Locate Speed:

Acceleration:

Servo Alarm Logic:

Negative Limit Logic:

Positive Limit Logic:

Focus Control

Precitec
 HighYAG
 Procutter-Zoom
 Ecac Ext Board[No Co:

Enable
 The fourth
 Pro

Range: From to

Focus position at

need pulse

High Speed: Origin Dir: Pos Neg

Low Speed: ORG signal:

Rollback distance:

Jog speed:

Locate Speed:

Acceleration:

Servo Alarm Logic:

Negative Limit Logic:

Positive Limit Logic:



The connections and settings may differ from one CNC control system to another. Once the setting is modified, the corresponding wiring method may need to be changed.

	°C	°C

4 Beam Alignment and Zero Focus Correction

- 1.
 - 2.
 - 3.
 - 4.
 - 5.
 - 6.
 - 7.
-

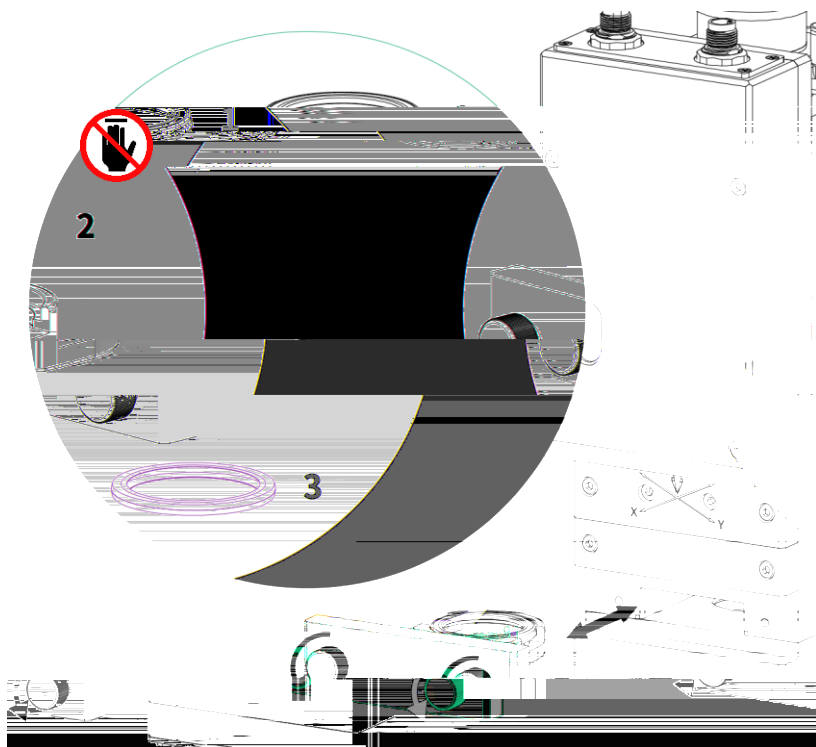

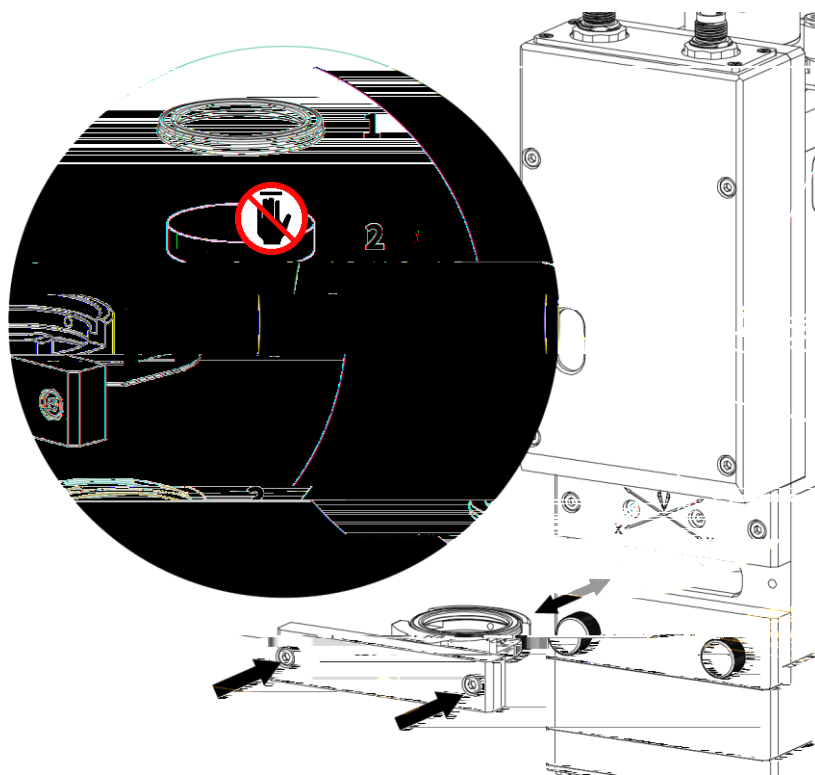

1.



